

DIMENSIONS & RECOMMENDED PATTERN

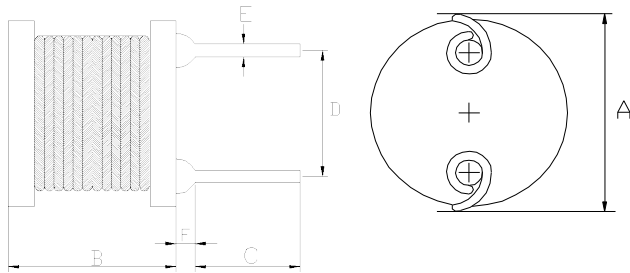

A: 7.8 Max.	mm
B: 8.5 Max.	mm
C: 15±2.0	mm
D: 3.0±0.5	mm
E: φ0.65±0.1	mm
F: 2.0 Max.	mm

※FEATURE

Applications:DC-DC converters,LCD Set,OA equipment,notebook, PDA

SELECTION GUIDE FOR STANDARD COILS:

MAGLAYERS PT/NO.	Inductance L(μH)	Percent Tolerance	Test Frequency	Resistance RDC(Ω)Max.	Rated DC Current
					IDC1(A)
GDR-0608-2R2□	2.2	M	100kHz/0.25V	16m	7.00
GDR-0608-3R3□	3.3	M	100kHz/0.25V	19m	5.50
GDR-0608-4R7□	4.7	M	100kHz/0.25V	23m	4.00
GDR-0608-100□	10	K,M	100kHz/0.25V	0.13	2.40
GDR-0608-150□	15	K,M	100kHz/0.25V	0.19	1.30
GDR-0608-220□	22	K,M	100kHz/0.25V	0.30	1.15
GDR-0608-270□	27	K,M	100kHz/0.25V	0.40	1.10
GDR-0608-330□	33	K,M	100kHz/0.25V	0.55	1.05
GDR-0608-390□	39	K,M	100kHz/0.25V	0.59	1.00
GDR-0608-470□	47	K,M	100kHz/0.25V	0.61	0.95
GDR-0608-500□	50	K,M	100kHz/0.25V	0.62	0.93
GDR-0608-680□	68	K,M	100kHz/0.25V	0.65	0.83
GDR-0608-101□	100	K,M	100kHz/0.25V	0.74	0.70
GDR-0608-221□	220	K,M	100kHz/0.25V	0.89	0.49
GDR-0608-391□	390	K,M	100kHz/0.25V	1.32	0.37
GDR-0608-471□	470	K,M	100kHz/0.25V	1.45	0.32
GDR-0608-561□	560	K,M	100kHz/0.25V	2.0	0.29
GDR-0608-821□	820	K,M	100kHz/0.25V	3.0	0.22
GDR-0608-152□	1500	J,K	10kHz/0.25V	4.5	0.18

※GENERAL SPECIFICATION:

※□ specify the inductance tolerance, J(±5%),K(±10%),M(±20%)

IDC1 : Based on inductance change (ΔL/Lo : drop 10% Max.) @ambient temperature 25°C

IDC2 : Based on temperature rise (ΔT : 40°C TYP.) Rated DC

Current : The less value which is IDC1 or IDC2.